



End Terraced House

32 Firthview Terrace, Ardrossan,





32 Firthview Terrace

Taylor and Henderson are delighted to bring to the market this Semi Detached villa located on a corner plot within residential area.

The accommodation comprises entrance hallway, lounge, modern fitted breakfasting kitchen with door leading to the garden, on the ground floor. Upstairs boasts 2 double bedrooms and fully tiled shower room. The property further benefits from double glazing, gas central heating & generous storage.

The front garden is laid in lawn rear with a paved driveway giving access to the detached garage. The side garden has a variety of mature plants and shrubs & the rear garden is laid in paving with a decked area.

Ardrossan and nearby Saltcoats offer a range of local amenities including beach, local shops, supermarket, restaurants, schools, train station and bus services. There is a regular ferry service to the Isle of Arran from Ardrossan Marina and a summer ferry service also provides regular sailings to the Kintyre peninsula. This excellent property is conveniently situated for all local amenities including road and regular rail links to Glasgow and all West Coast towns and thus is well located for travel throughout West Central Scotland.

Early viewing is highly recommended!

Measurements

Reception Hallway	
Lounge	14' x 13'
Breakfasting Kitchen	16'3 x 7'2
Bedroom 1	13' x 11'2
Bedroom 2	12'6 x 9'6
Shower Room	6'3 x 5'6



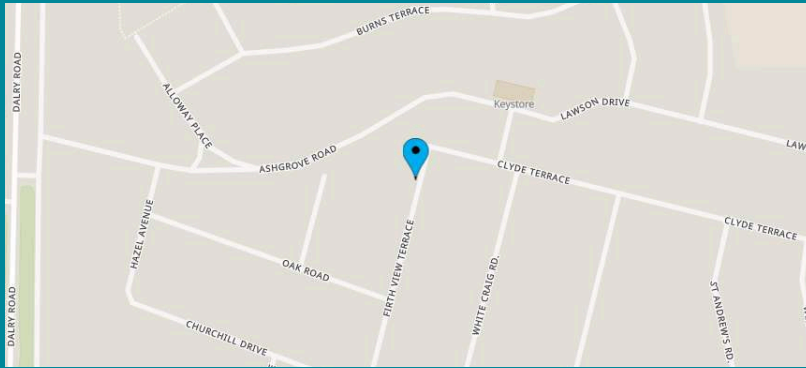

Viewing
Through solicitors on 01294 606700

Email
property@taylorandhenderson.co.uk

Reference
E479119

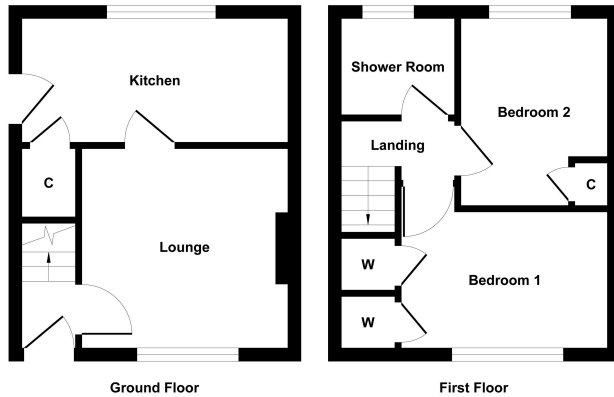

Illustration for identification purposes only, measurements are approximate, not to scale.
Produced by Elements Property

Our Offices

51 Hamilton Street, Saltcoats, Ayrshire, KA21 5DX
Tel: 01294 606700 & Fax: 01294 464827

22 Bank Street, Irvine, Ayrshire, KA12 0AG
Tel: 01294 278306 & Fax: 01294 272886

83 Main Street, Kilwinning, Ayrshire, KA13 6AN
Tel: 01294 557506 & Fax: 01294 558552
Email: property@taylorandhenderson.co.uk

espc rightmove  zoopla  OnTheMarket



DISCLAIMER: Whilst we endeavour to make these particulars as accurate as possible, they do not form part of any contract of offer, nor are they guaranteed. Measurements are approximate and in most cases are taken with a digital/sonic-measuring device and are taken to the widest point. We have not tested the electricity, gas or water services or any appliances. Photographs are reproduced for general information and it must not be inferred that any item is included for sale with the property. If there is any part of this that you find misleading or simply wish clarification on any point, please contact our office immediately when we will endeavour to assist you in any way possible.