



Main door Flat

31 Kersland Crescent, KILMARNOCK, KA1 5BS



taylorandhenderson.co.uk

1		2		1		D	EPC rating
---	--	---	--	---	--	---	----------------------

31 Kersland Crescent

Taylor & Henderson are delighted to offer to the market this freshly decorated main door ground floor flat located in the outskirts of Kilmarnock. The accommodation on offer comprises porch, hallway, lounge with feature fireplace, newly modern fitted kitchen with brand new door to the rear garden, 2 double bedrooms, brand new fitted bathroom with over bath shower. Features include new interior doors, new back door, new wooden floor through from the hallway lounge and kitchen, full new bathroom suite with wet wall in the kitchen and lounge, new ceiling in the kitchen and bathroom, fresh landscaped rear garden including new fence and garden hut, new light fittings in the hallway lounge and both bedrooms. Double glazing and gas central heating. The front garden is laid in chipped stones with a variety of mature shrubs paved walkway to the front door. The generous rear garden is newly landscaped with a generous drying green, patio area, chipped border and timber shed. Hurlford offers a range of local amenities including local shops, primary school and bus services. This property is conveniently situated for all local amenities.

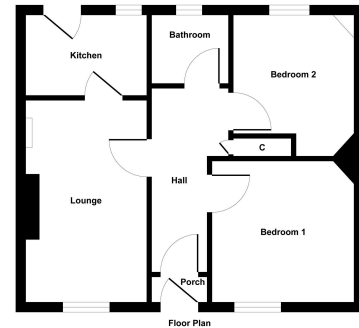

Illustration for identification purposes only, measurements are approximate, not to scale.
Produced by Daniels Property

Porch	3'4 x 3'2
Hall	15'7 x 3'4
Lounge	15'4 x 12'9
Kitchen	12'8 x 9'5
Bathroom	6'0 x 5'9
Bedroom 1	14'1 x 12'0
Bedroom 2	13'1 x 9'6

Viewing
Through solicitors on 01294 606700

Email
property@taylorandhenderson.co.uk

Reference E474122